

**Rinnai**



# Gas Fires

Contemporary Heating

# It's the real thing

## Stunning fireplace without the hassle

There's nothing more appealing than cosying up to romantic flickering flames. Framed in a sleek and modern casing, Rinnai's range of Gas Fires offer the relaxed ambiance of traditional fires without all the mess and hassle that goes with owning one.

Skillfully crafted with the latest technology, our Gas Fires push conventional boundaries by replicating the feel of a real fire with an efficiency of up to an impressive 5.5\* star energy rating.

Designed with meticulous attention for detail and installation flexibility, the range suits a wide range of applications. From retrofitting into existing fireplaces to easily fitting into new homes, Rinnai Gas Fires will create a stunning centrepiece and bring warmth into your home.

## At Rinnai, we're all about comfort

For over 50 years, Rinnai has supplied Australian homes with a range of appliances that help people lead comfortable, safe and efficient lifestyles.

Being driven to create comfort means that we really care about our products and your experience from start to finish. We're focused on developing products with the latest technology and our level of quality is second-to-none, so you can rest assured knowing Rinnai will deliver.

\*Star rating depends on installation and flueing configuration



# 650 & 750

Experience real radiance



## 650 & 750

The Rinnai 650 & 750 Gas Fires are the perfect solution to creating an ambient atmosphere. Experience the latest in design innovation, featuring Rinnai's exclusive ember bed technology.

With a flush, thin frame and wide viewing glass, these captivating Gas Fires create a beautiful look that will catch the eye of any design conscious individual.

Designed specifically to suit existing fireplaces with narrow dimensions, the 650 & 750 Gas Fires are ideal for smaller spaces.

All Rinnai 650 & 750 Gas Fires come with an easy to use remote, with room temperature display and flame control.

## Features

- High heat output up to 6kW of warmth
- Unique ember bed technology
- Easy to use remote, with room temperature display and flame control
- Wide viewing window with minimal frames
- Double glazed front - no need for a mesh guard, enhancing visual aesthetics
- Designed for replacement, renovations or new homes
- Available with either natural wood or glowing stones
- 3 or 4 sided fascia options available
- Wi-Fi (optional)



650 / 750 - Matte Black



650 / 750 - Titanium Grey



750 - Matte Black XL



650 / 750 - Glowing stones



650 / 750 - Natural wood log set



650 Freestanding Gas Fire (Matte Black)



# SS850

A touch of luxury and design



## SS850

### Inbuilt

Inspired by the much-loved Rinnai Sapphire, the SS850 is a stylish and versatile gas fire that is perfect for most homes. The modernised aesthetic, and the replacement of the glass heat shield with a barely visible mesh will ensure the SS850 will be another firm favourite Rinnai gas fire.

### Freestander

With simple modern lines, the SS850 is the perfect no-fuss replacement for a freestanding woodburner. The glowing logset and realistic flame picture will bring ambience and warmth to those cold winter nights. With a number of base options available, the SS850 has a look to suit your home.

With unique, modern style, the SS850 provides design flexibility that can be integrated into any living space. The Freestander is designed to be installed on a choice of fixed furniture, giving unlimited design opportunities.

## Features

- 3.9 Star energy efficiency
- High maximum heat output of 6.6 kW
- Subtle barely visible mesh guard
- Two base options available cabinet and plinth (shown below)
- Uses the coaxial direct vent flue system, sealed from the room
- Capable to be Wi-Fi enabled (with the addition of the Wi-Fi module)
- Available in LPG and Natural Gas
- Includes 'simple-to-use' infrared remote control



SS850 Built-In Co-Axial in Timber



SS850 Built-In Co-Linear in Masonry



SS850 Freestander



SS850 Freestander Plinth



SS850 Freestander Cabinet



SS850 Driftwood log set



# 950 & 1250

Gas Fires with wide appeal



## 950 & 1250

The 950 & 1250 Gas Fires create a bold statement but flick off the light in the room and romantic dancing flames come alive.

More than just a design feature both the 950 & 1250 Gas Fires come equipped with high-performing heat exchanger technology, rapid warm time & easy-to-use remote - all this with an incredible 5.5 star energy rating\*.

The combination of modern fascia designs and burn media options provide you with the ultimate flexibility to create a space that is truly your own. With optional side reflectors, the Rinnai 1250 also delivers an enhanced flame effect by creating depth for a more ambient surrounding.

## Features

- Incredibly energy efficient 5.5 star energy rating\*
- Powerful heating performance over 8kW (950) & 8.4kW (1250), perfect for open plan living and large areas\*\*
- Modern or classic? Select either pebbles or logs to suit your style
- Stainless steel or black? Select a fascia option to match your tastes
- Safety mesh guard to provide peace of mind and eliminate reflections
- Easy to use remote, with room temperature display and flame control
- Flexible flueing options
- Wi-Fi (optional)

\*When installed using extended flue.

\*\*When using short flue.



950 - Black on Black with Pebbles



1250 - Stainless Steel on Black Frame



Australian Eucalyptus log set



950 - Stainless Steel on Black with Eucalyptus Logs



1250 - Black on Black with Eucalyptus Logs



Glowing Pebbles with optional side reflector panel

# Wi-Fi Control

Complete comfort at your fingertips

## Features

- Utilising your Wi-Fi network to allow for seamless control
- Remotely control your heater via the cloud
- Monitor and thermostatically control your temperature
- Wi-Fi control that is compatible with both iOS and Android smart devices
- Full control flame settings and programmable timer



## Wi-Fi Features

Control Features	650/750	SS850	950/1250
Power On/Off	•	•	•
Temperature Setting	•	•	•
Flame Control	•	•	•
Multi Timer On/Off	•	•	•
Ember Glow On/Off	•		

## Model Compatibility

Wi-Fi available on the following Rinnai models.

650	750	SS850	950	1250
650ENGN	750ENGN	Inbuilt N/L	952ENGN	1252ENGN
650ENGL	750ENGL	Freestander N/L	952ENGL	1252ENGL

For further information speak to your Rinnai Specialist Dealer.



# Installation Options

## Creating a False Fireplace

Whether you are building a new home, working through a major renovation or just want to revamp your living room, the Rinnai zero clearance option is the perfect solution to creating a new space.

If your home doesn't have an existing fireplace, creating a false fireplace is the next best thing. To ensure an easy installation into a timber frame or other combustible materials, the Rinnai SS850, 1250 and 950 are designed with an integrated zero clearance box.

The 650 and 750 require an additional zero clearance frame.

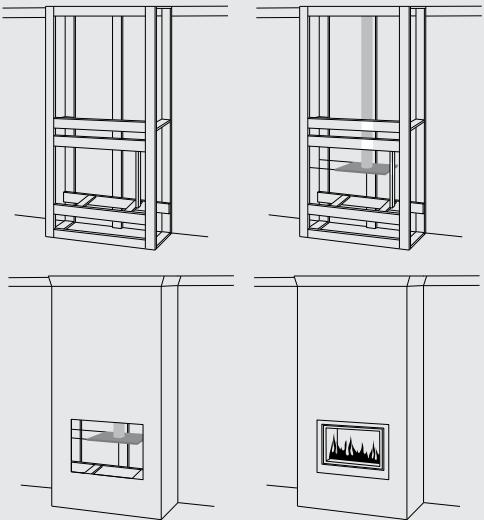

## Weatherproof Box

For an alternative installation to a false fireplace, the Rinnai 1250, 950, 750 & 650 can be installed into a weatherproof box.

A cavity is cut into the existing blank wall and the fireplace is installed onto a bracket that allows the back of the fire to sit outside housed in a tightly sealed box. This option allows the fire to be built into an existing wall without taking up any extra space in the room. The weatherproof box is sold separately.

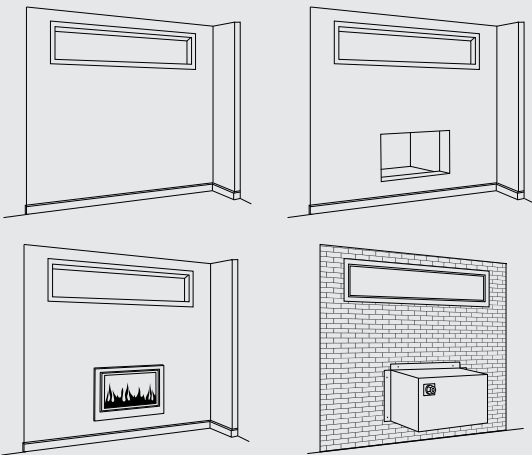

## Existing Masonry Fireplace

Another great option for many homes is installing a Gas Fireplace into an existing brick chimney. Turn an unused fireplace into a stunning feature or replace an existing Gas Heater with a Rinnai Gas Fireplace to create the ultimate solution for comfortable living. The Rinnai SS850, 650 & 750 are designed to suit existing masonry fireplaces.

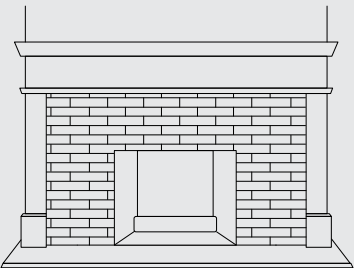

# Flue Installation Options

## 650 / 750

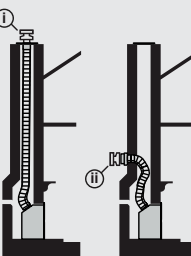

**Masonry**  
i. Vertical  
ii. Horizontal

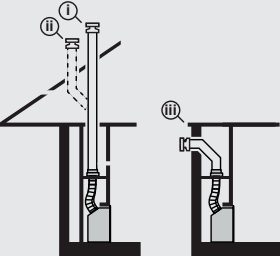

**False Fire Place**  
i. Vertical  
ii. Vertical Offset  
iii. Horizontal



**Weather Proof Box**  
Reduces the internal footprint requirements of the heater engine

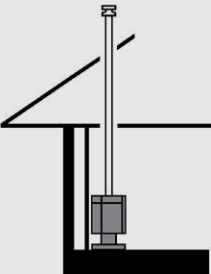

**650 Free Standing**  
Flue - FS650KIT01

## 950 / 1250

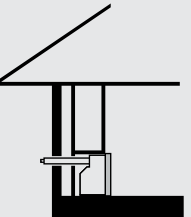

**Rear External Wall**

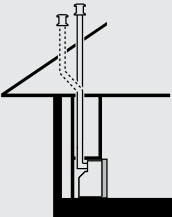

**Vertical**

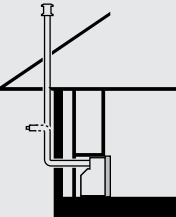

**Through Wall**

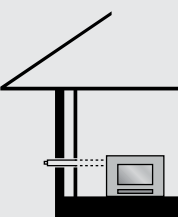

**Sideways Through Wall**

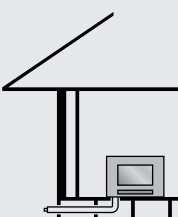

**Down and Out**

## SS850

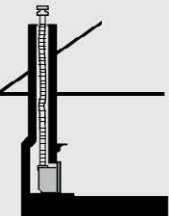

**Inbuilt - Masonry**

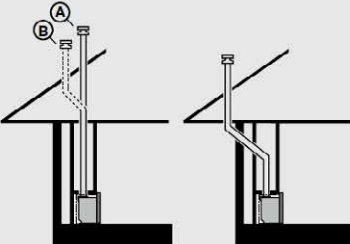

**Inbuilt - Zero Clearance**

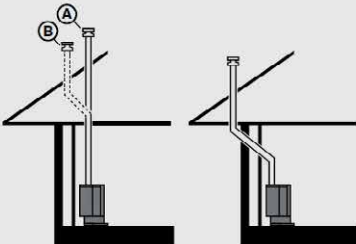

**Free Standing - Console & Plinth**

(A) Direct flue (B) Offset flue

For further flueing information please refer to the installation instructions.

# Specifications

## Specifications

Model	Style	Visual Dimensions (mm)			Inbuilt Cavity Dimensions (mm)			Efficiency Star Rating AS4553	Colour Options	Gas Input MJ/h		Output kW	'Heats up to' Capacity (m²)*		
		H	W	D	H	W	D			Low	High		Cold	Cool	Mild
650	Freestanding	895	645	445	N/A	N/A	N/A	3.7*	Black	14	23	5.00	55	74	85
650	Inbuilt	645	640	5	600	600	400	3.7*	Titanium Grey Matte Black Matte Black XL	14	23	5.00	55	74	85
750	Inbuilt	645	740	5	600	700	400	3.7*		14	27	6.00	65	87	99
650	Zero Clearance	645	640	5	700	700	400	3.7*		14	23	5.00	55	74	85
750	Zero Clearance	645	740	5	700	800	400	3.7*		14	27	6.00	65	87	99
SS850	Freestanding / Plinth	925	735	395	N/A	N/A	N/A	3.9*	Matte Black	14	30	6.6	65	95	112
SS850	Freestanding / Cabinet	1055	735	395	N/A	N/A	N/A	3.9*		14	30	6.6	65	95	112
SS850	Freestanding	685	735	395	N/A	N/A	N/A	3.9*		14	30	6.6	65	95	112
SS850	Inbuilt – mock chimney	660	865	25	655	800	370	3.9*		14	30	6.6	65	95	112
SS850	Inbuilt – masonry	660	865	25	600	700	370	3.9*	Stainless Steel / Black Black / Black	14	30	6.6	65	95	112
950	Inbuilt	620	1020	25	600	965	570	5.5*		10	34	8.00	82	110	125
1250	Inbuilt	620	1320	25	570	1265	570	5.5*		10	34	8.40	82	110	125

## Warranty

Model	Heat Exchanger	Fan	All Other Parts	Labour
Complete Gas Fire range	10 Years Pro Rata Domestic 1 Year Commercial	2 Years Domestic 1 Year Commercial	1 Year Domestic 1 Year Commercial	1 Year Domestic 1 Year Commercial

\*Star-rating depends on installation and flueing configuration.

Rinnai Gas Fires appliances are fitted with either a 'heat guard mesh' or layered glass as the primary safety guards. Some installations, for example where young children are present, may require the purchase of an additional, third party safety guard. For more information please refer to owner and installation manual accompanying the heater. With our policy of continuous improvement, we reserve the right to change, or discontinue at any time, specifications or designs without notice.

Note: All images contained within this brochure are for illustrative purposes only, the colours and finishes of the products featured are as close to the respective product range as photographic lighting and printing processes allow.







**Rinnai Australia Pty Ltd**

ABN 74 005 138 769

100 Atlantic Drive,  
Keysborough, Victoria 3173

For further information  
call 1300 555 545 or visit  
[rinnai.com.au](http://rinnai.com.au)

**TOTAL HOME COMFORT**



HOT WATER



HEATING



COOLING

**Rinnai**