

11. Parts List and Exploded Diagrams

NOTE:

Some Part details may have changed since publication of this manual. Contact Rinnai to confirm spare parts details before ordering.

IHF10			Effective: 4/4/17 Supercedes: 13/11/14 Issue: 3
No	RA DESCRIPTION	RA CODE	TR PART
1	PANEL FRONT IHF10	92099801	S-HFB-1192H
2	SCREW PANEL FRONT IHF10	92099823	HZB-0705
3	SEAL INSUL IHF10		HGB-2045
4	PLATE INSUL A IHF10		HZB-0915X01
5	PLATE INSUL B IHF10		HZB-0927
6	PILOT ASSY LP IHF10	92099833	HIA-0041L
6	PILOT ASSY NG IHF10	92099805	HIA-0041N
6.1	PILOT HEAD IHF10	92099830	HIB-0007
6.2	ELECTRODE IHF10	92099839	HEP-0006
6.3	FLAME ROD IHF10	92099813	HES-0011
6.4	INJECTOR PILOT LP IHF10	92099815	HIN-3501
6.4	INJECTOR PILOT NG IHF10	92099840	HIN-6001
6.5	N/A USE No 6		HIZ-0306
6.6	N/A USE No 6		HIZ-0107
7	BURNER MAIN ASSY LP IHF10	92099807	S-HBA-1545L
7	BURNER MAIN ASSY NG IHF10	92099802	S-HBA-1545N
7.1	INJECTOR MAIN LP IHF10	92099828	S-HBT-1531L
7.1	INJECTOR MAIN NG IHF10	92099809	S-HBT-1531N
7.2	N/A USE No 7		HBB-1512
8	PLATE BURNER IHF10		HBB-3808
9	THERMISTOR IHF10	92099803	HEU-0007
10	HEAT EXCH IHF10	92099822	S-HUA-1063
10.1	VALVE PRESS RELIEF IHF10	92099834	S-HWP-0005
11	OHS IHF10	92099818	HEF-0016
12	FLUE TRANS IHF10		HXB-0088
13	FLUE TERMINAL MAIN IHF10	92099835	HOB-0021CG
14	FLUE BAFFLE IHF10	92099811	HOT-0109A
15	FLUE SPACERS IHF10	92099804	HOT-0207
16	FLUE TERMINAL TOP IHF10	92099814	HOT-0113CG
17	GAS CONTROL LP IHF10	92099825	S-HSA-0124L
17	GAS CONTROL NG IHF10	92099816	S-HSA-0124N
17.1	VALVE GAS MOD LP IHF10	92099827	HSD-1058L
17.1	VALVE GAS MOD NG IHF10	92099836	HSD-1058-1N
18A	DIAPHRAGM WATER GOVERNOR	92099858	
18	WATER SECTION IHF10	92099831	HWA-0083
19	VALVE GAS SERVO IHF10 NG	92099812	HEE-0032x01
19	VALVE GAS SERVO IHF10 LPG	92099851	HEE-0032
20	PLATE INSUL REAR IHF10		HZB-0926
21	BATTERY CASE IHF10	92099837	HEZ-0206X01
22	PCB MAIN IHF10	92099824	HEI-1053
23	HARNESS WIRING IHF10	92099817	HEW-0132
24	PLATE FIX BATT IHF10		HEZ-0129
25	PCB TEMP IHF 10	92099806	HEZ-3001
26	HARNESS VALVE MOD IHF10		HEZ-3002

No	RA DESCRIPTION	RA CODE	TR PART
27	CLIP RETAINING IHF10	92099829	HWF-0404
28	INLET WATER IHF10	92099819	HWB-3023
28a	FILTER WATER 0 LARGE	92083773	
29	RESTRICTOR WATER IHF10	92099838	HZC-2004
30	INLET PIPE IHF10	92099808	S-HUE-2015
31	CLIP WIRE OHS IHF10		HZB-2201
32	PANEL REAR IHF10		HCB-0171
33	TEST POINT REG INLET LP IHF10	92099826	S-HZC-1103L
34	TEST POINT REG INLET NG IHF10	92099820	S-HZC-1103N
35	REGULATOR LP IHF10	92099821	HSG-0013L
35	REGULATOR NG IHF10	92099810	HSG-0013N
36	ADAPTOR GAS IHF10	92099832	S-HZC-1104
37	GASKET	92099850	HGB2048
38	WATER FLOW ADJUSTMENT KIT	92099852	/

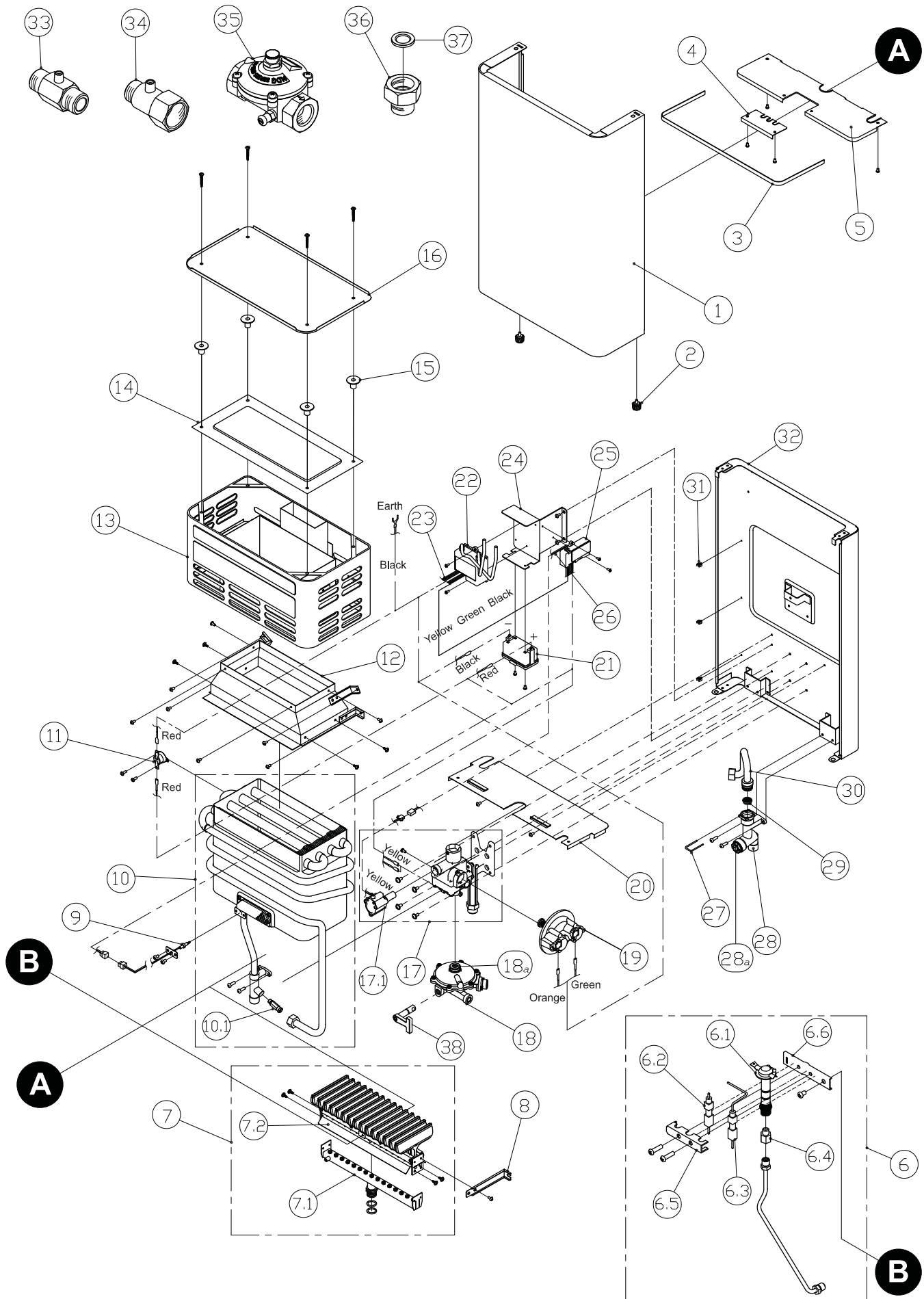

Intentionally Blank

Rinnai

Rinnai Australia Pty. Ltd. ABN 74 005 138 769

Head Office

100 Atlantic Drive,
Keysborough, Victoria 3173
P.O. Box 460
Braeside, Victoria 3195
Tel: (03) 9271 6625
Fax: (03) 9271 6622

Rinnai has a Service and Spare Parts network with personnel who are fully trained and equipped to give the best service on your Rinnai appliance. If your appliance requires service, please call our National Help Line. Rinnai recommends that this appliance be serviced every 2 years.

Internet: www.rinnai.com.au E-mail: enquiry@rinnai.com.au

National Help Line

Tel: 1300 555 545* Fax: 1300 555 655*

**Cost of a local call higher from mobile or public phones.*