

Pipe Cover – PC12W & PC12BLK

Installation Instruction

GENERAL INFORMATION

The pipe cover is designed to conform with the hot water heater and is approximately the same width and depth of the appliance. An installed pipe cover conceals 400mm of pipework below the appliance. Pipe covers can be joined to one another, with each additional pipe cover extending the amount of concealment by a further 400mm.

The pipe covers in this manual are designed to fit specific Rinnai Continuous Flow Water Heater models. Ensure the correct pipe cover is being installed by confirming the model number against that found on the appliance data plate.

PC12W	
Infinity B12	REU-BM1220W
Infinity B16	REU-BM1620W
Infinity B20	REU-BM2024W
Infinity B26	REU-BM2626W

PC12BLK	
B26 Black	REU-A2626WB

INSTALLATION METHOD

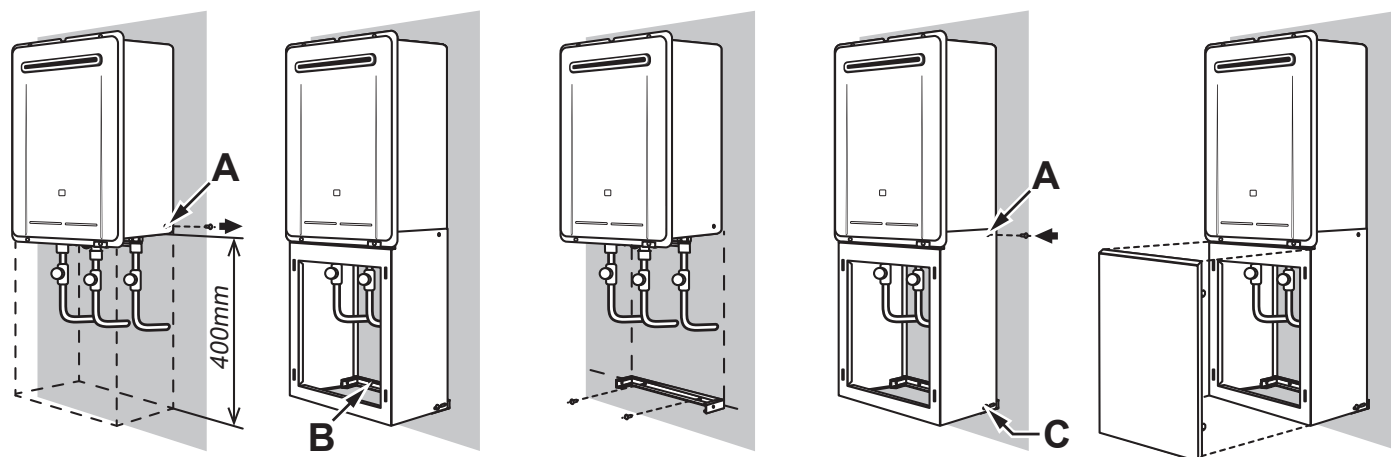

1. Install water heater and connections, then remove screws (**A**) from the lower side panels of the water heater.
2. With the pipe cover held in the installed position, mark the location of the wall bracket securing holes (**B**).
3. Secure the wall bracket with suitable fixings at the location marked in step 2.
4. Secure pipe cover to water heater with the screws (**A**) removed in step 2
5. Secure pipe cover to wall bracket (**C**) with screws provided, use elongated holes to keep components square.
6. Fit the front panel to complete the installation.

INSTALLATION OF ADDITIONAL PIPE COVERS

1. Install the first pipe cover, as per the installation methods described on pages 1 or 2.
2. With the second pipe cover held in the installed position, mark the location of the upper screw holes (**A**) onto the first pipe cover, also mark the location of the wall bracket securing holes (**B**) of the second pipe cover.
3. Secure the second wall bracket with suitable fixings at the location marked in step 2.
4. Carefully drill 3mm holes into the first pipe cover at the locations marked in step 2.
5. Secure both pipe covers together with two installer supplied short self-tapping screws (**A**).
6. Secure second pipe cover to wall bracket (**C**) with the screws provided, use elongated holes to keep components square.
7. Fit the front panels to complete the installation.

Repeat this method as required for each additional pipe cover to be installed.

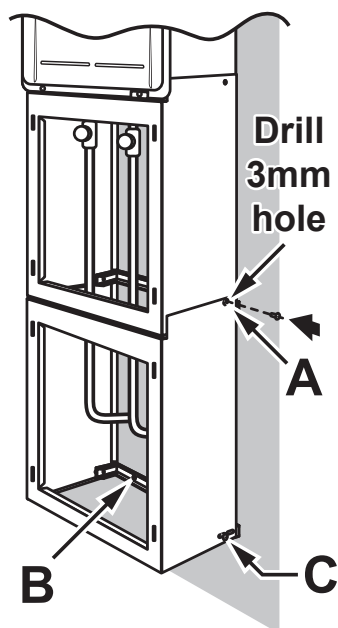

Rinnai Australia Pty Ltd

ABN 74 005 138 769 AU45204

82-88 Mills Road, Braeside, Victoria, 3195

P.O. Box 460, Braeside, Victoria, 3195

Tel: (03) 9271 6625

Customer Support

Tel: 1300 555 545*

Hot Water Service Line

Tel: 1800 000 340*

**Cost of a local call may be higher from a mobile phone.*

(National calls from public phones in Australia are free.)

For further information visit www.rinnai.com.au or email enquiry@rinnai.com.au

Rinnai has a Service and Spare Parts network with personnel who are fully trained and equipped to give the best service on your Rinnai appliance.

If your appliance requires service, please call Customer Support.

With our policy of continuous improvement, we reserve the right to change, or discontinue at any time, specifications or designs without notice.