

MODEL
CNTRLDRCINW2

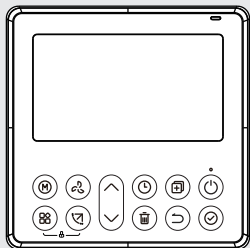

Wired Remote Controller

Operation and Installation Manual

Rinnai

Congratulations on the purchase of your Rinnai Wired Remote Controller.

This manual describes safety precautions required for the use of the product.

- Read this manual carefully before installing or operating your wired remote controller. Make sure you understand the information provided before attempting to use the product.
- Keep this manual where it is readily accessible after reading it through.
- If another user operates the product in the future, be sure to hand over this manual to the new user.
- All the pictures in this manual are for explanation purpose only. They may be slightly different from the wired remote controller you purchased and the actual shape shall prevail.

This Wired Controller is compatible with the following Rinnai indoor models:

DRCi	Hi-Wall		Slim Ducted	Compact Cassettes	Floor Console
	PB Series	PX Series			
DINLR07B1A	HINRP20MB	HINRPX20M	DINSD26MB	CIN020RMB	FINRP50MB
DINLR09B1A	HINRP26MB	HINRPX25M	DINSD35MB	CIN026RMB	
DINLR11B1A	HINRP35MB	HINRPX35M	DINSD50MB	CIN035RMB	
DINLR13B1A	HINRP50MB	HINRPX50M	DINSD70MB	CIN050RMB	
DINLR15B1SA	HINRP60MB	HINRPX60M	DINSD26MBA		
DINLR18B1SA	HINRP70MB	HINRPX70M	DINSD35MBA		
	HINRP80MB	HINRPX80M	DINSD50MBA		



This controller contains features and functions that are applicable to certain models in 1:1 and Multi configurations. In brackets next to the associated feature or function the applicable models will be listed, if no models are listed the feature or function is applicable to all.

1:1 - This configuration contains one outdoor unit and one indoor unit.

Multi - This configuration contains one outdoor unit and two or more indoor units. The only models that may be installed in a multi configuration are Hi-Wall and Slim Ducted units, DRCi is a 1:1 configuration.

1.0 TABLE OF CONTENTS

1.	Safety Precautions	7
2.	Accessory Installation	9
3.	Installation Method	10
	Wired remote controller dimensions	10
	Thermostat connection to Indoor Unit	12
	Setting up two Controllers	12
4.	Specifications	16
	Wiring Specifications	16
5.	Features	17
	Feature and functions of the wired controller	17
6.	LCD Display	18
7.	Controller buttons	19
8.	Settings prior to Operation	20
	Setting the current day and time	20

9. Operation	21
To start/stop operation.....	21
To set the operation mode	21
Room temperature setting.....	21
Fan speed setting.....	22
Keypad tone setting	22
ECO	22
SLEEP.....	23
GEAR.....	23
Child lock function	24
8-degree heating function	25
Swing function (units with horizontal & vertical swing features).....	25
Swing function (units without vertical swing function)	26
Turbo function	27
Active Clean	27
Follow me function indicator.....	27
10. Timer Functions	28
To set the On or Off Timer.....	29
To set Day On or Off.....	30
11. Weekly Timer 1	31
WEEKLY timer operation.....	33

Delay function	35
12. Weekly Timer 2	37
Delete the time scale in one day	43
13. Fault Codes	44
Fault Alarm Handling	44
Technical Requirements	44
14. Wireless Control Connection	45
Safety Precautions	45
Use Your Appliance with the NetHome Plus App	47
Register or Login account	48
Add Your Appliance	49
Choose Your Device Type	50
Connected to the Network	51
16. How to Use App	52
Special Functions	54
17. Warranty	58
Contacts	60

1. SAFETY PRECAUTIONS



- This wired controller must be installed only by an Authorised Person.
- Installation by other persons may lead to imperfect installation, electric shock or fire.
- Adhere to this installation manual.
- Improper installation may lead to electric shock or fire.
- Reinstallation must be made by an Authorised Person.
- Do not uninstall the unit randomly. Arbitrarily uninstalling may lead to abnormal operation, heating or fire of the air condition.



- Do not install the unit in a place vulnerable to leakage or flammable gases. Once flammable gases are leaked and left around the wire controller, fire may occur.
- Do not operate with wet hands or let water enter the wired controller. Otherwise, electric shock may occur.
- The wiring should adapt to the wired controller's current. Otherwise, electric leakage or heating may occur and result in fire.
- The specified cables shall be applied in the wiring. No external force may be applied to the terminal.
- The illustrations used in this manual are for explanatory purposes only.



BEFORE INSTALLING THE WIRED CONTROLLER

- This manual provides instructions for installing the wired controller. Please refer to the wiring diagram of this installation manual for connecting the wired controller with indoor unit.
- The wired controller operates in a low voltage loop circuit. Strictly **DO NOT** directly contact the high voltage cable above, such as 115V,220V,380V. **DO NOT** wire this type of cabling in the said loop; wiring clearance between configured tubes should range between 300~500mm or above.
- The shielded wire of the wired controller must be grounded firmly.
- After completing the wire controller connection, **DO NOT** use Megger tester to check the insulation. That may damage the product.



A maximum of two CNTRLDRCINW2 controllers may be installed on a system.



This appliance is **NOT** intended for use by persons (including children) with reduced physical, sensory or mental capabilities, or lack of experience and knowledge, unless they have been given supervision or instruction concerning use of the appliance by a person responsible for their safety. Children should be supervised to ensure that they **DO NOT** play with the appliance.

2. ACCESSORY INSTALLATION

Select the installation location

Avoid installing this product in areas with heavy oil, vapour, or sulfureted gas because it can cause the system to deform and malfunction.

Preparation before installation

1. Please confirm that all the following parts have been supplied.

No.	Name	Qty	Remarks
1	Wired Controller	1	—
2	Operation & Installation Manual	1	—
3	Screws	3	ST 3.9*25 (For mounting on the wall)
4	Wall Plugs	3	For Mounting on the Wall



This controller does not contain batteries.



All the illustrations in this manual are for explanation purposes only. Your wired controller may be slightly different. The actual shape shall prevail.

3. INSTALLATION METHOD

Wired remote controller dimensions

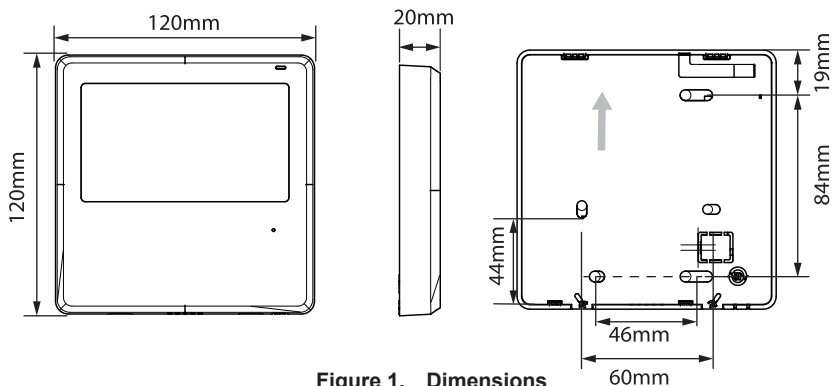

Remove backing plate from the wired controller

- Insert a flat screwdriver into the slots in the lower part of the wired controller (2 places). Rotate the screwdriver (2 places) to remove the backing plate (Figure 2).

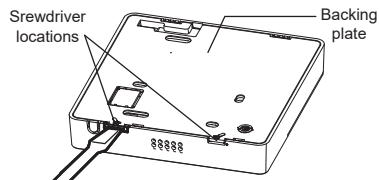

Do not pry up and down, you can only rotate the screwdriver.



The PCB is mounted in the upper part of the wired controller. Be careful not to damage the board with the slot screwdriver.

Fasten the backing plate of the wired controller

- Fasten the backing plate on the wall with the 3 screws (ST3.9*25) and plugs (Figure 3) provided.

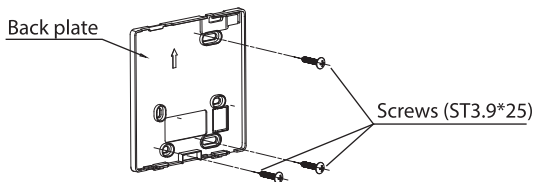

Figure 3.

Loom access point

- Remove plastic knockout from the backing plate (Figure 4).
- Create a hole in the wall to access the wall cavity for routing the loom from FCU to controller.

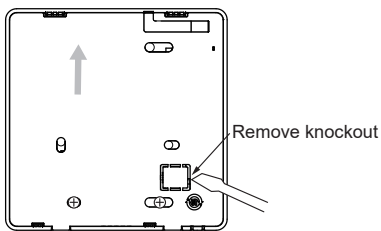

Figure 4.



Put on a flat surface. Be careful not to distort the back plate of the wire controller by over tightening the mounting screws.

Thermostat connection to Indoor Unit

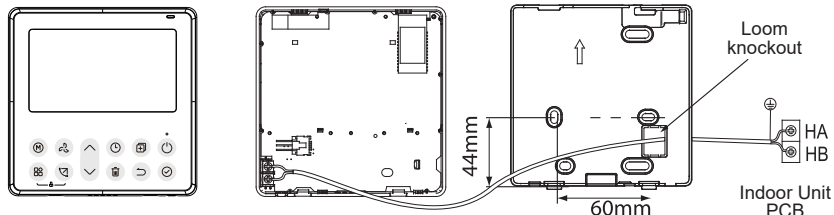



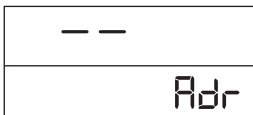





Figure 5. Model A

Setting up two Controllers

To configure a secondary CNTRLDRGINW controller do the following:

- 1 With both controllers connected, turn power to the system ON at the isolating switch.
- 2  Go to the proposed secondary controller and press the copy button.
- 3  Press the confirm button to access parameters.
- 4  Press the up button \wedge until ' - - ' and 'Adr' appear on the screen as shown below.



-
- 5  Press the Confirm button to access controller address options.
-
- 6  Press the Up button \wedge until 'b' appears as shown below.
- | |
|-----|
| b |
| Adr |
-
- 7  Press the Confirm button to accept address changes.
-
- 8  Press the back button twice to save and return to the home screen.
- | | |
|-----|-----|
| b | SUB |
| Adr | |

10 The system may now be operated by either controller. If two controllers are installed the secondary 'SUB' controller is not capable of the following functions:

- Setting Time and Date
- Weekly Schedule
- Timer On / Off

Wi-Fi control may be setup on one of the controllers only. There is no polarity between HA and HB (Figure 6).

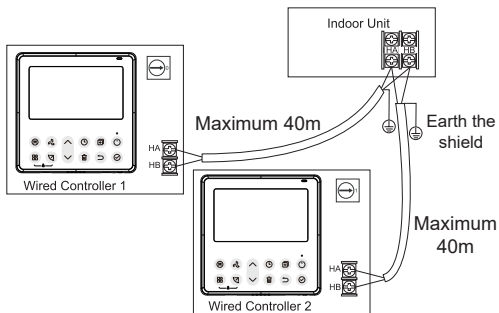

Figure 6.



DO NOT allow water to enter the wired control. Use the trap and putty to seal the wires. Connecting wires must be fixed reliably and cannot be pulled.

For some units, one wired controller can support multiple units (a maximum of 16 units). For configuration of multiple indoor units loom connection is polarity sensitive and HA must connect to HA on all indoor units, the same applies to HB. In group control, there will be no error displayed on the wired controller (Figure 7).

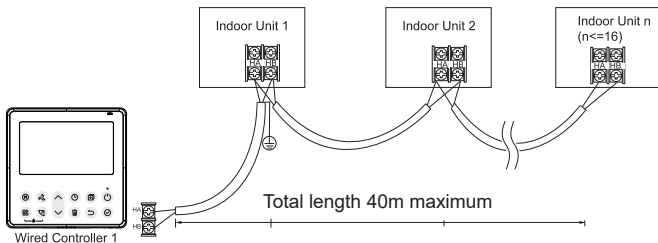

Figure 7.

Indoor Unit

Connect the terminals on the wired controller (HA ,HB), and the terminals of the indoor unit (HA ,HB). There is no polarity between HA and HB (Figure 8).

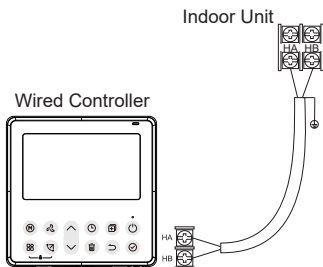

Figure 8.

Reattach backing plate of the wired controller

To reconnect the fascia to the backing plate, anchor the top lugs first as shown below then swing the fascia down and press lightly to engage the bottom tabs, be careful not pinch the loom during this process (Figure 9).

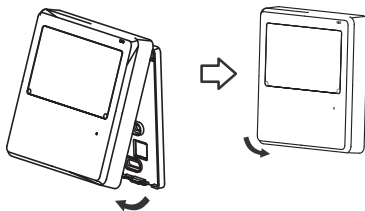

Figure 9.

4. SPECIFICATIONS

Model	CNTRLDRCINW2
Input Voltage	5V~24V
Ambient Temperature	-5~43°C
Ambient Humidity	RH40%~RH90%

Wiring Specifications



Controller loom shall be 2-Core shielded cable, 2 x 0.5mm.sq minimum, Rinnai part number CNTRLLOOM2W18M is 18m long and it may be used.

5. FEATURES

Feature and functions of the wired controller

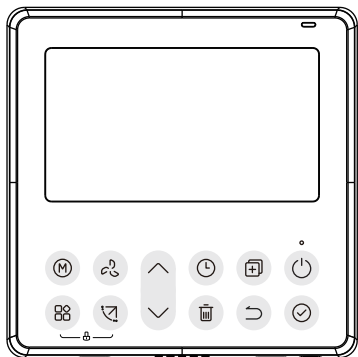

- LCD Display.
- Malfunction Code Display: shows the error code which is ideal for service.
- 4-way wire layout design. No raised section at back-end so more convenient to fit the wires and install the device.
- Room Temperature Display.
- Weekly Timer.

Function:

- Mode: Choose Auto-Cool-Dry-Heat-Fan
- Fan speed: Auto/Low/Med/High speed
- Swing (on some models)
- Timer ON/OFF
- Temp Setting
- Weekly Timer
- Follow Me
- Turbo
- 24-hour System
- 12-hour System
- Auto Restart
- Individual Louver Control (on some models)
- Automatic Airflow Test
- Rotation & Back-up
- Dual Control
- Group Control
- Child Lock
- LCD Display
- Clock

6. LCD DISPLAY

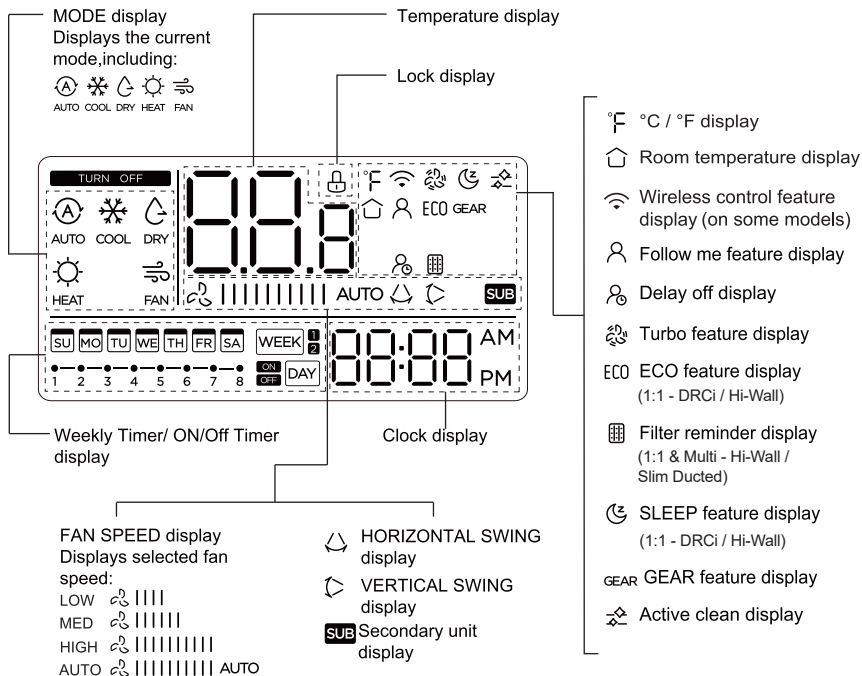

7. CONTROLLER BUTTONS

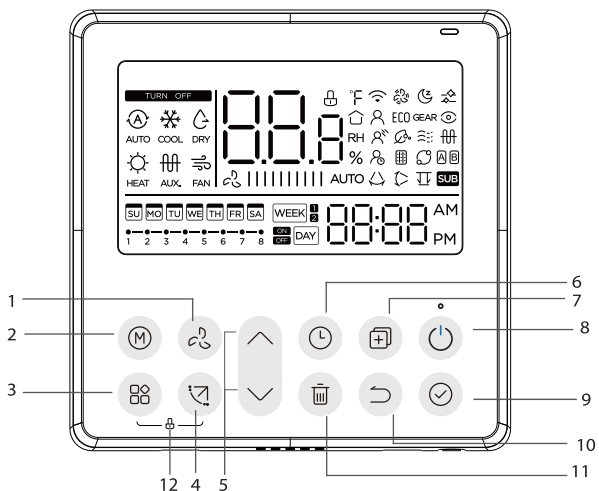

- | | | | |
|----------|-------------------------|-----------|-----------------------------|
| 1 | FAN SPEED button | 7 | COPY button |
| 2 | MODE button | 8 | POWER button |
| 3 | FUNC. button | 9 | CONFIRM button |
| 4 | SWING button | 10 | BACK button |
| 5 | ADJUST button | 11 | DAY OFF/DELAY button |
| 6 | TIMER button | 12 | CHILD LOCK button |

8. SETTINGS PRIOR TO OPERATION

Setting the current day and time



Press the Timer button for 2 seconds or more. The timer display will flash.



Press the button “∨” or “∧” to set the date. The selected date will flash.



The date setting is finished and the timer setting is prepared after pressing Timer button or CONFIRM button or do not press button for 10 seconds.



Press the button “∨” or “∧” to set the current time. Press repeatedly to adjust the current time in 1-minute increments. Press and hold to adjust the current time continuously.



ex.Monday 11:20



To complete the setting, press the CONFIRM button or do not press button for 10 seconds.



Time scale selection
Press the buttons “(L)” and “(III)” for 2 seconds. This will alternate the clock display between the 12hr & 24hr scale.

9. OPERATION

To start/stop operation



Press the Power button.

To set the operation mode

Operation mode setting (Heat mode is invalid for cooling only type unit).



Press this button to select the operation mode:



Room temperature setting



Lower

Press the button “∨” or “∧” to set the room temperature.

Indoor Setting Temperature Range:

16/17~30°C or 20~28°C. (Model dependent)



Raise



°C & °F scale selection (on some models).

Pressing the buttons “∧” and “∨” for 3 seconds will alternate the temperature display between the °C & °F scale.

Fan speed setting



Press the “Fan speed button” to set the fan speed.
(This button is unavailable under Auto or Dry mode.)

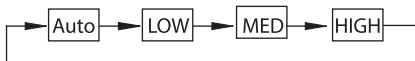

Keypad tone setting



Press the buttons “(M)” and “(Fan speed)” together for 3 seconds to turn the keypad tone on or off.



ECO

There may be times when you need to manage and reduce the noise level emitted by your outdoor unit, possibly at night.

This feature gradually reduces the performance of your system over an eight hour period to around 50%.

The rotational speed of the compressor and outdoor fan assemblies slow down incrementally every two hours.

At completion of the ECO cycle your system will return to normal operation.

To activate ECO press the FUNC. button “” and then up/down arrows to highlight ECO, press the confirm button “” to select.

To cancel ECO prematurely press the Mode button “(M)” and select the mode of operation.

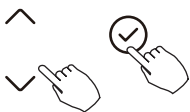

Press the button “∨” or “∧” to set the operation mode, then press the Confirm button to confirm the setting.

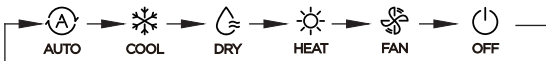

SLEEP

This feature would typically be activated when heading off to sleep and run for eight hours. In Cooling mode the set point temperature will rise by 1°C in the first hour and another 1°C in the second hour. In Heat mode the set point temperature will decrease by 1°C in the first hour and another 1°C in the second hour.

For the remaining six hours the setpoint temperature will remain unchanged and at completion of the cycle the system will return to normal operation.

To activate SLEEP press the FUNC. button “☐☐” and then up/down arrows to highlight SLEEP, press the confirm button “☑” to select.

To cancel SLEEP prematurely, press the Mode button “(M)” and select the mode of operation.

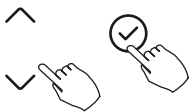

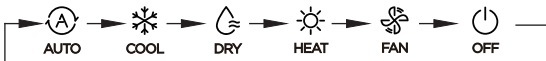

Press the button “∨” or “∧” to set the operation mode, then press the Confirm button to confirm the setting.



GEAR

This feature like ECO will change the outdoor unit's compressor and fan assemblies rotational speeds.

The compressor rotation speed will reduce with a reduction of the compressor's frequency from 100% to 75%, 50% or OFF.

To activate GEAR press the FUNC. button “ ” and then up/down arrows to highlight GEAR, press the confirm button “ ” to select.

After five seconds the temperature setpoint screen will display, press the up/down arrows to increase/decrease the setpoint temperature then press the confirm “ ” button to save and action GEAR.

To cancel GEAR press the Mode button “ ” and select the mode of operation.



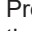
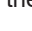

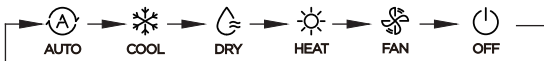
Press the button “” or “” to set the operation mode, then press the Confirm button to confirm the setting.



Child lock function



Press the “” and “” buttons for 3 seconds to activate the child lock function and lock all buttons on the wired controller.

You can't press the button to operate and receive the remote control signal after the child lock is activated.

Press these two buttons again for 3 seconds to deactivate the child lock function.

When the child lock function is activated, the “” symbol appears.

8-degree heating function

(1:1 - Hi-Wall / DRCi)

This function allows the system to heat a room to a minimum of 8°C, acting as a frost protection or 'keep warm' setting and is activated by selecting the dedicated heating mode on the controller.



When the heating mode is 16°C / 17°C / 20°C, press the 'down' button twice within 1 second to turn on the 8-degree heating function. Then press the Power, Mode, Adjust, Fan speed, Timer, and Swing button to cancel the 8-degree heating function.



For some models, the 8-degree heating function can only be set by remote control, you can not choose this function by wired controller.

Swing function (units with horizontal & vertical swing features)

(1:1 & Multi – Hi-Wall)

1 Up-Down Swing



Press the "SWING" button to start Up-Down swing function. The "⏮" symbol appears. Press again to stop.

2 Left-Right Swing

Press the "SWING" button for 2 seconds to activate Left-Right Swing function. The "⏮" symbol appears. To stop, press again for 2 seconds.

Swing function (units without vertical swing function)

(1:1 & Multi – Hi-Wall)



- Use the “Swing” button to adjust the Up-Down airflow direction and start the auto swing function.

1. Each time you press this button, the louver swings at an angle of 6 degrees. Press this button until the desired direction is reached.
 2. Press and hold the button for 2 seconds to activate the auto swing. The “◁” symbol appears. To stop, press button again (some units).
- For the units with four Up-Down louvers, it can be operated individually.
 1. Press the Swing button to activate the Up-Down adjusting louver function.



The “◁” symbol will flash. (Not applicable on all the models.)

2. Pressing the button “∨” or “∧” can select the movement of four louvers. Each time you push the button, the louver will be selected in a sequence as:
(◻-0 means the four louvers move at the same time.)

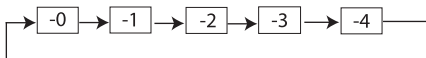

3. Use Swing button to adjust the Up-Down airflow direction of the selected louver.



Press the FUNC. button to scroll through the operation functions as follows:

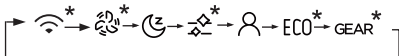

[*]: Model dependent. If the indoor unit does not have this function, it will not display.
The selected function icon will flash, then press the Confirm button to confirm the setting.

Turbo function

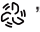

Under the COOL/HEAT mode, press the FUNCTION button to activate the turbo function. Press the button again to deactivate the turbo function. When the turbo function is activated the “” symbol appears.

Active Clean



This process assists with cleaning the indoor coil and depending on the appliance it can take up to 90 minutes to complete.

Follow me function indicator

Press the FUNCTION button to select whether the room temperature is detected at the indoor unit or the wire controller.

When the follow me function  symbol appears, the room temperature is detected by the wired controller. Press the button again to cancel the follow me function.

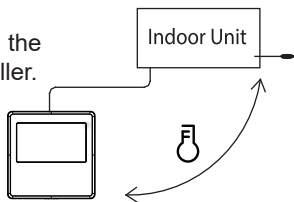

10. TIMER FUNCTIONS

WEEK

WEEKLY Timer

Use this timer function to set operating times for each day of the week.

ON

DAY

On Timer

Use this timer function to start air conditioner operation. The timer operates and air conditioner operation starts after the time has passed.

OFF

DAY

Off Timer

Use this timer function to stop air conditioner operation.

The timer operates and air conditioner operation stops after the time has passed.

ON
OFF

DAY

On and Off Timer

Use this timer function to start and stop air conditioner operation.

The timer operates and air conditioner operation starts and stops after the time has passed.

To set the On or Off Timer

- 1  When “ day on ” or “ day off ” is selected the [ON] or [OFF] icon will flash, and the temperature display area will also flash.

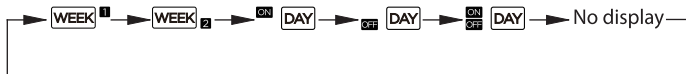



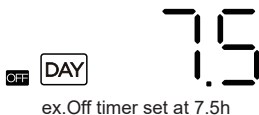

- 2 

Press buttons “∨” or “∧” to select the timer duration, in 0.5 hour increments.

- 3  Press the Confirm button to activate the timer and complete the setting.

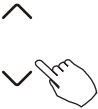
To set Day On or Off

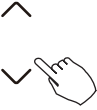
-  When “ day on off” is selected, the [ON] icon will flash, and the [OFF] icon will light up.
-  Use the “∨” or “∧” buttons to select the “ on ” timer duration, in 0.5 hour increments.
-  Press the confirm button to activate the “ on ” timer duration; at this point, the [ON] icon will light up, and the [OFF] icon will flash.
-  Use the “∨” or “∧” buttons to select the “ off ” timer duration, in 0.5 hour increments.
-  Press the confirm button to activate the “ off ” timer duration and complete the setting.



The secondary wired controller cannot set the timer.

11. WEEKLY TIMER 1

1 Weekly timer setting



Press the Timer button to select the **WEEK** , then press the Confirm button to confirm the setting.



2 Day of the week setting



Press the button “ \vee ” or “ \wedge ” to select the day of the week, then press the Confirm button to confirm the setting.



3 ON timer setting of timer setting 1



Press the button “ \vee ” or “ \wedge ” to select the time of the On timer, then press the Confirm button to confirm the setting.





ex. Tuesday time scale 1

Up to 4 timer settings can be saved for each day of the week. It is convenient if the WEEKLY TIMER is set according to user's lifestyle.

4 Off timer setting of timer setting 1



Press the button “∨” or “∧” to set the time for the Off timer, then press the Confirm button to confirm the setting.



ex. Tuesday time scale 1

- 5 Different timer settings can be set by repeating Steps 3 to 4.
- 6 Other days in one week can be set by repeating Steps 2 to 5.



The weekly timer setting can be returned to the previous step by pressing 'Back' button. The time of Timer setting can be deleted by pressing 'Day off' button. The current setting will be restored and withdrawn the weekly timer setting automatically when there is no operation for 30 seconds.

WEEKLY timer operation

To activate WEEKLY TIMER operation



Press the Timer button while **WEEK** is displayed on the LCD.

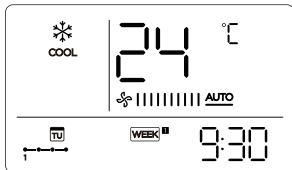

To deactivate WEEKLY TIMER operation



Press the Timer button when **WEEK** has disappeared from the LCD.

To turn off the air conditioner during the weekly timer



1. By pressing the Power button once and quickly, the air conditioner will turn off temporarily. The air conditioner will turn on automatically when the time is shown on the On Timer.

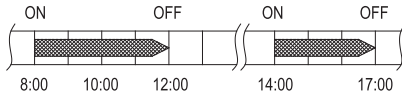



ex. By pressing the POWER button once and quickly at 10:00, the air conditioner will turn on at 14:00

2. By pressing the Power button for 2 seconds, the air conditioner will turn off completely, simultaneously cancelling the timing function.

To set for DAY OFF (for a holiday)

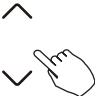
1  During the weekly timer setting, press the Confirm button.

2  Press the button “∨” or “∧” to select the day in this week.

3  Press the Day off button to set for DAY OFF.

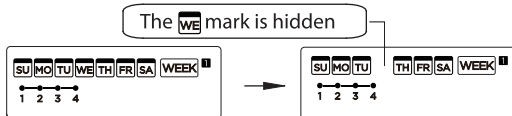

ex.The DAY OFF is set for Wednesday

4 The DAY OFF can be set for other days by repeating Steps 2 and 3.

5  Press the Back button to return to the weekly timer.

To cancel, follow the same procedure as those for setup.



The DAY OFF setting is cancelled automatically after the set day has passed.

Delay function



During the weekly timer, press the FUNC. button. Select the delay function and press the Confirm button. Display will show “0h” “1h” “2h” then wait 3 seconds to confirm. When the delay function is activated, the “⌘” symbol will appear.



The delay function can only be enabled in Weekly Timer 1 and Weekly Timer 2.

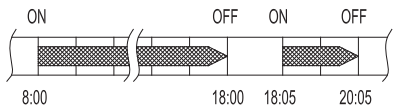
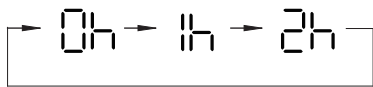

ex. By selecting “2h” at 18:05, the air conditioner will be delayed in turning off until 20:05.

Copying setting from one day into another

A schedule once made may be copied from one day to another day of the week. The entire schedule of one selected day of the week can be copied.



During the weekly timer, press the Confirm button.

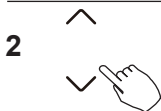

Press the button “∨” or “∧” to select which day to copy settings from.



Press the Copy button, the letters “CY” will appear on the LCD.



Press the button “∨” or “∧” to select the day to copy to.



Press the Copy button to confirm.

The  mark flashes quickly

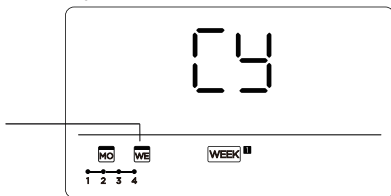

ex. Copy the setting of Monday to Wednesday

6 Other days can be copied by repeating Steps 4 and 5.



Press the Confirm button to confirm the settings.



Press the Back button to return to the weekly timer.

12. WEEKLY TIMER 2

1 Weekly timer setting



Press the Timer button to select the **WEEK** , then press the Confirm button to confirm the setting.

2 Day of the week setting



Press the button “∨” or “∧” to select the day of the week, then press the Confirm button to confirm the setting.



3 ON timer setting of timer setting 1



Press the button “∨” or “∧” to select the setting time. The setting time, mode, temperature and fan speed appear on the LCD. Press the Confirm button to confirm the setting.



Up to 8 scheduled events can be set on one day.

Various events can be scheduled in either **MODE**, **TEMPERATURE** and **FAN** speeds.

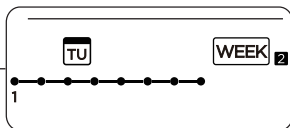

ex. Tuesday time scale 1

4 Time setting



Press the button “∨” or “∧” to select the time, then press the Confirm button to confirm the setting.

5 Operation mode setting

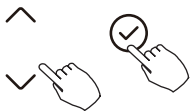

Press the button “∨” or “∧” to set the operation mode, then press the Confirm button to confirm the setting.

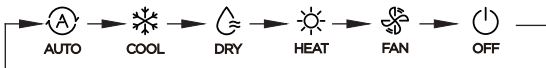

6 Room temperature setting*

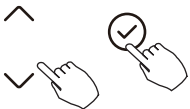

Press the button “∨” or “∧” to set the room temperature, then press the Confirm button to confirm the setting.

* *This setting is unavailable in the FAN or OFF modes.*

7 Fan Speed Setting*



Press the button “∨” or “∧” to set the fan speed, then press the Confirm button to confirm the setting.

** This setting is unavailable in the AUTO, DRY or OFF modes.*

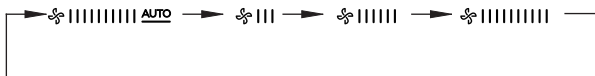

8 Different scheduled events can be set by repeating Steps 3 through to 7.

9 Additional days, in a one week period, can be set by repeating Steps 3 through to 8.



The weekly timer setting can be returned to the previous step by pressing BACK. The current setting will be restored. The controller will not save the weekly timer settings if there is no operation within 30 seconds.

WEEKLY timer operation

To start



Press the Timer to select the **WEEK** . The timer will start automatically.

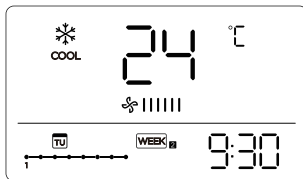

ex.

To cancel



Press the Power buttons for 2 seconds to cancel the timer mode.



The timer mode can also be canceled by changing the timer mode by using the Timer.

To set the DAY OFF (for a holiday)



After setting the weekly timer, press the Confirm button to confirm the setting.

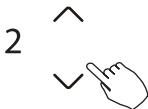

Press the button “v” or “^” to select the day of the week.

3



Press the Day off button to set for DAY OFF.



ex.The DAY OFF is set for Wednesday

4

The DAY OFF can be set for other days by repeating Steps 2 and 3.

5



Press the Back button to return to the weekly timer.

To cancel, follow the same procedure as those for setup.



The DAY OFF setting is cancelled automatically after the set day has passed.

Copying setting from one day into another

A schedule once made may be copied from one day to another day of the week. The entire schedule of one selected day of the week can be copied.

1



During the weekly timer, press the Confirm button.

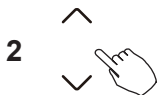

Press the button “∨” or “∧” to select which day to copy settings from.



Press the Copy button, the letters “CY” will appear on the LCD.



Press the button “∨” or “∧” to select the day to copy to.



Press the Copy button to confirm.

The **WE** mark flashes quickly

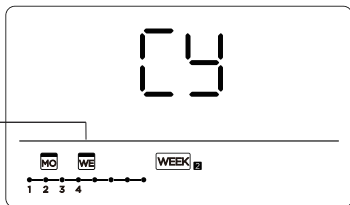

ex. Copy the setting of Monday to Wednesday

6 Other days can be copied by repeating Steps 4 and 5.





Press the Confirm button to confirm the settings.

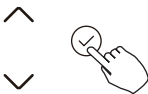

Press the Back button to return to the weekly timer.

Delete the time scale in one day

-  During the weekly timer setting, press the Confirm button.
-  Press the button “∨” or “∧” to select the day of the week. Press the CONFIRM button to confirm settings.
-  Press the button “∨” or “∧” to select the setting time to be deleted. The setting time, mode, temperature and fan speed will appear on the LCD. The setting time, mode, temperature and fan speed can be deleted by pressing the DEL (day off) button.

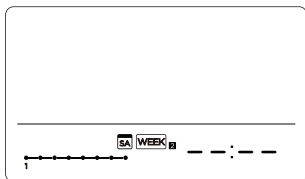
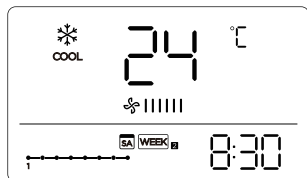

ex. Delete the time scale 1 in Saturday

13. FAULT CODES

Fault Alarm Handling

If the system does not properly operate except the above mentioned cases or the above mentioned malfunctions is evident, investigate the system according to the following procedures.

No.	Definition of Fault	Wall Control Digital Display
1	Error of communication between wired controller and indoor unit	EHE3

If the error code appears, please have a service technician attend for service.

Technical Requirements

EMC and EMI comply with the CE certification requirements.

14. WIRELESS CONTROL CONNECTION

Safety Precautions

App Compatibility:

- The app is available for both iOS and Android, however older versions may no longer be compatible. Please keep the app updated with the latest version. Midea makes no guarantee of compatibility and is not responsible for issues arising as a consequence thereof.
- The app is subject to updates without prior notice for product function improvement.



- **APP can not support the latest software version of Android and iOS system.**
- **Due to special circumstances that have occurred, we explicitly claim below: Not all of the Android and iOS systems are compatible with APP. We will not be responsible for any issues as a result of the incompatibility.**

Wireless Security:

- The Smart Kit supports the following security protocols: WPA-PSK / WPA2-PSK / WPA3-SAE
- It may be used with or without encryption although encryption is strongly recommended.

Connectivity:

- Network issues may occasionally cause timeouts. The unit display and the app may become unsynchronized but this will resolve itself when the network is restored.

Should the network remain unavailable, it might be necessary to run the configuration process again. Change in the wireless network will require reconfiguration of the device.

Configuration:

- The actual network configuration process may vary slightly from the manual.
- Please check the service website for more information.

Restore to factory settings:

- When the user deletes the device on the APP, the module automatically restores to the factory settings.

This equipment should be installed and operated with a minimum distance of 20cm between the smart kit and your body.



- **Smart Phone camera needs to be 5 million pixels or above to ensure QR scan works sufficiently.**
- **Due to different network conditions, occasionally a response time-out occurs. Therefore, it may be necessary to repeat network configuration.**
- **Due to different network set-ups, sometimes control process may return time-out. If this occurs, the display between board and App may not be the same. This is not an issue.**



Rinnai will not be liable for any issues and problems caused by Internet, Wi-Fi Router and Smart Devices. Please contact the original provider for assistance.

Use Your Appliance with the NetHome Plus App

- Ensure that your mobile phone is connected to the home wireless network, the 2.4GHz band wireless signal is enabled on your wireless router and you know the network password.
- Turn on Bluetooth on your phone and the device must also be powered up.



The following QR Code is only available for downloading the APP.

Android Phone Users

Scan Android QR code or go to Google Play and search “NetHome Plus” APP and download the app.

iOS Users

Scan iOS QR code or go to APP Store and search “NetHome Plus” APP and download the app.





Android





iOS



How to enter AP distribution network

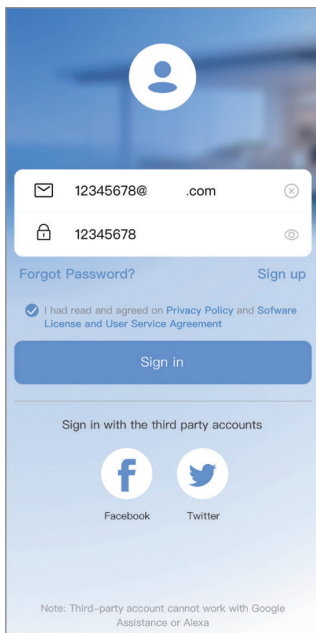

Press the FUNC. button until the  icon is selected and then press the CONFIRM button. AP mode is activated if the  symbol is flashing.

Register or Login account





 12345678@ .com 



 12345678 

[Forgot Password?](#) [Sign up](#)

I had read and agreed on [Privacy Policy](#) and [Software License and User Service Agreement](#)

[Sign in](#)

Sign in with the third party accounts

 

Facebook Twitter

Note: Third-party account cannot work with Google Assistance or Alexa

Open the App and create a user account, if you already have one, just log in.

Add Your Appliance

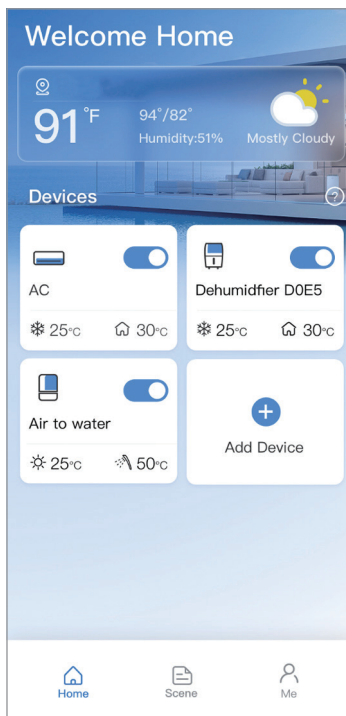

Tap the “+” icon to add home appliance to your NetHome Plus account.

Choose Your Device Type

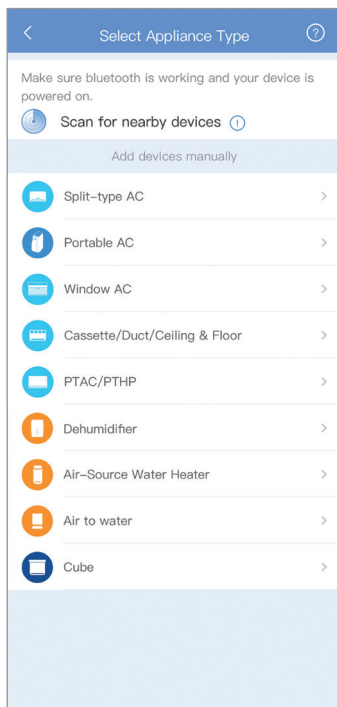

Connected to the Network

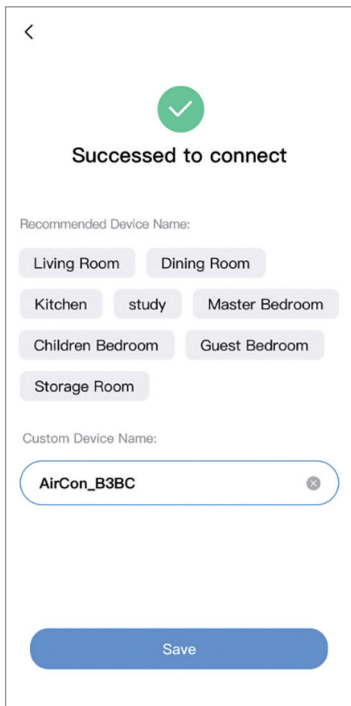

<



Succeeded to connect

Recommended Device Name:

Living Room Dining Room

Kitchen study Master Bedroom

Children Bedroom Guest Bedroom

Storage Room

Custom Device Name:

AirCon_B3BC

Save

Follow the instructions in the App to set up the Wireless connection. If the network connection fails, please refer to the App tips for operation. The actual UI design may look different from examples due to App updates.

16. HOW TO USE APP

- Please ensure your mobile device is connected to the Wi-Fi router. Make sure the Wi-Fi router is connected to the internet before using the App to control the air conditioner via internet. Please follow the next steps.

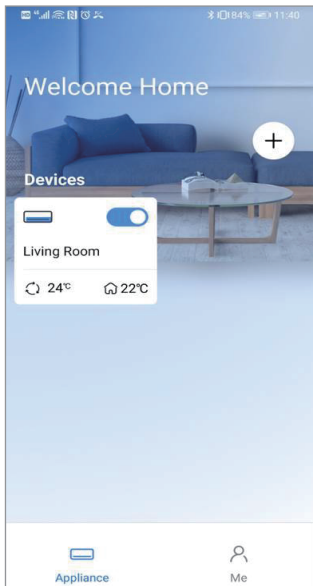
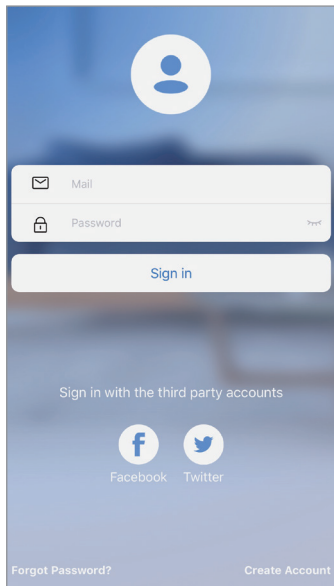

1. Type your account and password and sign in.
2. Select your appliance.



3. Touch to turn on. The user can control the AC on/off status, operation mode, fan speed, temperature, etc.



NOTE Depending on your specific air conditioning system, some functions may not be controllable.

Special Functions

■ Schedule

User can schedule daily to turn air conditioner ON/OFF at any specific time of day during the week. User also can choose circulation to keep the AC under schedule control every week.

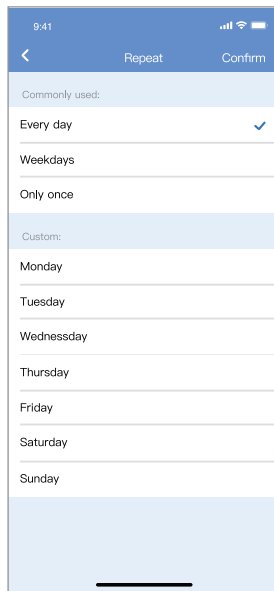
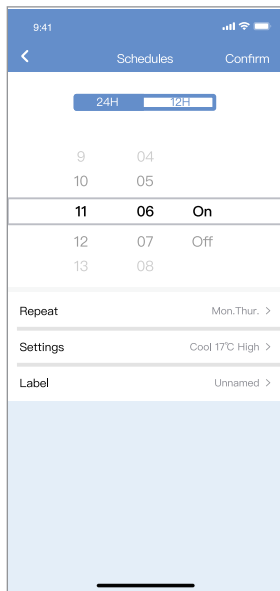
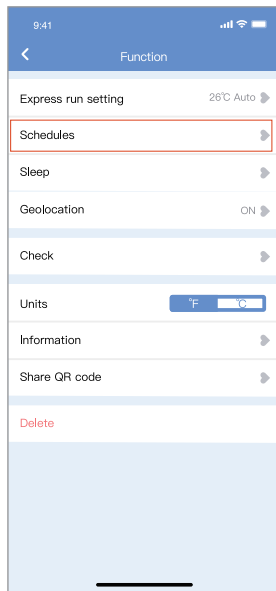

■ Sleep

User can customise their own comfortable sleep by setting an overnight target temperature. To access Sleep, system must already be operating in heating or cooling mode.

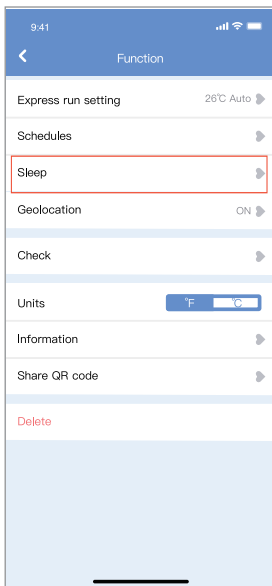

Specification

This device is in compliance with the essential requirements and other relevant provisions of Directive 2014/53/EU. (European Union products only.)

- Wireless Module Model: EU-SK107, US-SK107, EU-SK110, US-SK110
- Antenna Type: Printed PCB Antenna
- Wireless: 2400 - 2483.5MHz, TX Power: < 20dBm Operation
- Temperature: 0°C~45°C/32°F~113°F Operation Humidity: 10%~85%
- Power Input: DC 5V/500mA
- BLE: 2402 - 2480MHz, TX Power: < 10dBm

CAUTIONS

Wireless Network module models: US-SK107, EU-SK107:

FCC ID: 2ADQOMDNA21

IC: 12575A-MDNA21

This device complies with Part 15 of the FCC Rules and it contains licence-exempt transmitter(s)/receiver(s) that comply with Innovation, Science and Economic Development Canada's licence-exempt RSS(s).

Operation is subject to the following two conditions:

- (1) This device may not cause interference; and
- (2) This device must accept any interference, including interference that may cause undesired operation of the device.

Only operate the device in accordance with the instructions supplied.

Changes or modifications to this unit not expressly approved by the party responsible for compliance could void the user's authority to operate the equipment.

This device complies with FCC radiation exposure limits set forth for an uncontrolled environment. In order to avoid the possibility of exceeding the FCC radio frequency exposure limits, human proximity to the antenna shall not be less than 20cm (8 inches) during normal operation.



This equipment has been tested and found to comply with the limits for a Class B digital device, pursuant to part 15 of the FCC Rules.

These limits are designed to provide reasonable protection against harmful interference in a residential installation. This equipment generates, uses and can radiate radio frequency energy and, if not installed and used in accordance with the instructions, may cause harmful interference to radio communications. However, there is no guarantee that interference will not occur in a particular installation.

If this equipment does cause harmful interference to radio or television reception, which can be determined by turning the equipment off and on, the user is encouraged to try to correct the interference by one or more of the following measures:

- **Reorient or relocate the receiving antenna.**
- **Increase the separation between the equipment and receiver.**
- **Connect the equipment into an outlet on a circuit different from that to which the receiver is connected.**
- **Consult the dealer or an experienced radio/TV technician for help.**

17. WARRANTY

TERMS OF WARRANTY – AUSTRALIA

Rinnai Australia Pty. Ltd. ABN 74 005 138 769

82-88 Mills Road, Braeside, Victoria, 3195

NOTICE TO CONSUMERS UNDER AUSTRALIAN CONSUMER LAW

Our goods come with guarantees that cannot be excluded under the Australian Consumer Law. You are entitled to a replacement or refund for a major failure and compensation for any other reasonably foreseeable loss or damage. You are also entitled to have the goods repaired or replaced if the goods fail to be of acceptable quality and the failure does not amount to a major failure.

Our services come with guarantees that cannot be excluded under the Australian Consumer Law. For a major failure with the service, you are entitled to cancel your service contract with us and obtain a refund for the unused portion, or to compensation for its reduced value. You are also entitled to be compensated for any other reasonably foreseeable loss or damage. If the failure does not amount to a major failure you are entitled to have problems with the service rectified in a reasonable time and, if this is not done, to cancel your contract and obtain a refund for the unused portion of the contract.

The benefits provided by this Warranty are in addition to any other rights and remedies available to a consumer under the Australian Consumer Law and any other law which may apply to the goods and or services.

WARRANTY: DRCi R32 Wired Controller

This product is warranted for a period of one (1) year from the date of purchase, in accordance with the Terms and Conditions of Warranty detailed below.

IMPORTANT – TO BE READ IN CONJUNCTION WITH THE TERMS AND CONDITIONS OF WARRANTY

- The fitness for purpose of the Rinnai DRCi R32 Wired Controller and ensuring suitable Wi-Fi connectivity is the sole responsibility of the Qualified Installer and or Purchaser.
- The DRCi R32 Wired Controller must be installed by a suitably Qualified Installer in accordance with local and national wiring codes, otherwise the warranty will be void.
- Always refer to the Installation and Owner's Manuals to ensure the correct installation and operation procedures have been followed.
- The DRCi R32 Wired Controller is to be installed indoors only; warranty excludes damage caused by the elements such as rain, wind, lightning, or harmful environmental conditions.
- For full Terms and Conditions, go to the Rinnai website, www.rinnai.com.au

Rinnai Australia Pty Ltd

ABN 74 005 138 769 | AU45204

82-88 Mills Road, Braeside, Victoria, 3195
P.O. Box 460, Braeside, Victoria, 3195
Tel: (03) 9271 6625

Customer Support

Tel: 1300 555 545*

Monday to Friday, 8.00 am to 5.00 pm EST.

**Cost of a local call may be higher from a mobile phone.
(National calls from public phones in Australia are free.)*

For further information visit **www.rinnai.com.au**
or email **enquiry@rinnai.com.au**

Rinnai has a Service and Spare Parts network with personnel who are fully trained and equipped to give the best service on your Rinnai appliance. If your appliance requires service, please call Customer Support.

With our policy of continuous improvement, we reserve the right to change, or discontinue at any time, specifications or designs without notice.